

Company Profile 2023

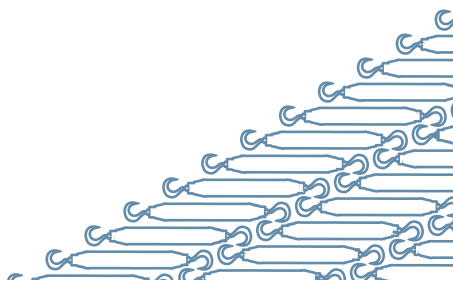

About us

In SEVEN HANDS, we work enthusiastically to provide a considerable technical office quality by providing leading edge in Architecture, Structure, MEP, and Infrastructure as well as expanding our knowledge regionally.

SEVEN HANDS is proud to have successfully accomplished a long list of projects in Egypt, KSA, and QATAR. In addition, we also aspire to enter the other middle east construction markets and offer our services in this promising region.

Moreover, we are committed to developing our intellectual capital to achieve excellence in the quality of service. We are dedicated to building a long-term relationship based on trust, and developing strategy for optimizing resources to generate healthy growth in profit while making a positive contribution to our community.

Our Vision

To become a Technical Office market leader/pioneer in connecting people to the latest technology & creating sustainable solutions essential to a better and safer life for people.

Our Mission Statement

As a Technical Office Engineering company, we offer our services in the following specializations: Architectural, Structural, Electrical, Mechanical, Infrastructure. Our main objective is to be the Middle East leader in this scope.

We are keen to be always updated with the latest technologies related to all services we offer as we hire experts with highly motivated spirits in all fields we work in.

SEVEN HANDS is proud to be seen amongst the most respected Firms in the market that manages to combine between values added Integrated Solutions as well as an ethic.

Our Services

The Name of **SEVEN HANDS** comes from the **SEVEN** services we proud to offer

Carrying Out Engineering Design verification, and Preparing Calculations.

Implementing BIM methodologies that produce 3D Revit BIM Modeling, Clash Detection, Constructability Review, and 4D/5D Construction Simulation.

Attending meetings with contractors, consultants and owners, preparing Reports, and Submittals.

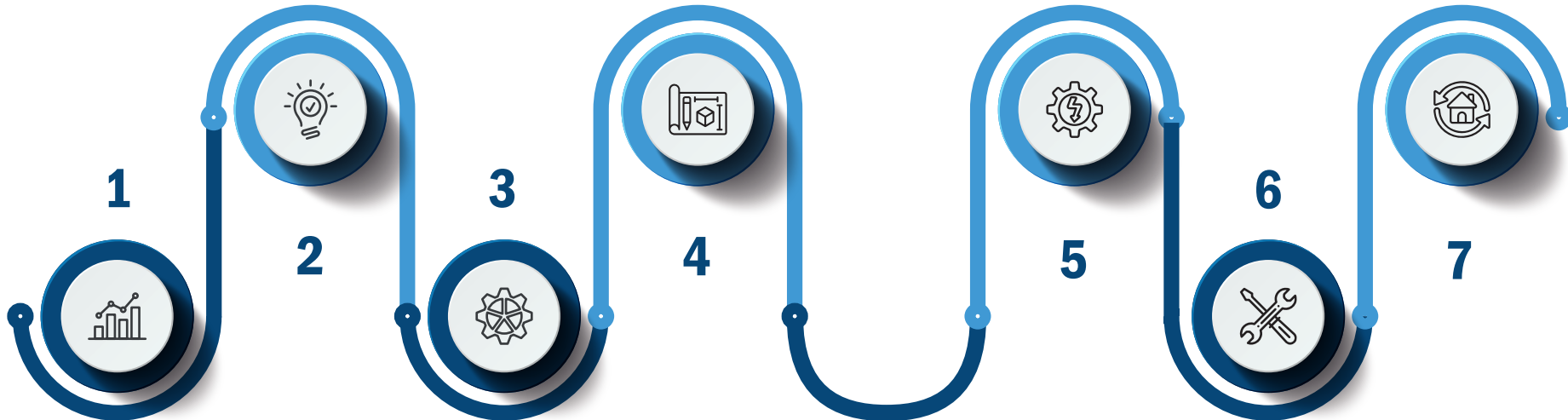

Preparing and Processing Shop Drawings, and other Contractor Submittals.

Coordinate all Project Disciplines (Architecture, Structure, and Electromechanical Drawings).

Preparation of Quantity Takeoffs, Material Takeoffs, and Construction Estimation.

Offering Training Courses in all Engineering disciplines.

Scope of Works:

Architecture

- Architecture and furniture plans.
- Block work plans (Masonry plans).
- Landscaping plans.
- Ceiling & Flooring plans.
- Wet area shop drawing & designing.
- Life safety system.
- Elevations and sections details.
- Facades and finishes.
- Stairs & Elevator details.
- Interior design details.

Structure

- **Civil Engineering verification design of concrete and steel structures, Drawings Preparation and Engineering calculations preforming.**
- **Shop Drawing submittals of all structural elements using (CAD, ASD, and REVIT).**
- **Feasibility study for the structural system.**

Infrastructure

Design and shop drawings of the following elements:

- **Roads: including plans, profiles, and cross sections**
- **Mechanical works including: water Supply, Sewage, firefighting, and irrigation networks.**
- **Mechanical structures including: Chambers, pump stations, and manholes.**
- **Architectural Landscape works including: flooring, furniture, and lighting.**
- **Electrical works including: Medium voltage, low voltage, landscape lighting, and telecom.**

Scope of Works:

MEP

Electrical works

- Lighting & Power system.
- Cable routing
- Electrical Station Furniture
- Earthing System and Lighting Protection

Low Current Systems

- Telephone and Data System.
- Car parking system.
- Fire Alarm System
- Access Control System.
- Home automation.
- IP Telephone and digital phone systems

HVAC System:

- Air-conditioning equipment & station
- Chilled water pipes network
- Ventilation system.
- Mechanical Room (AHU, Chiller, Cooling Towers, Boiler Clarifier.)
- VRF System

Firefighting System

- Firefighting sprinkler system (Water - Gas and Dry).
- Fire Cabinet and Extinguishing System.
- Co2, FM200, and Kitchen Hood Fire Suppression System.
- Firefighting pump Room and Water Tank.

Plumbing System

- Water supply and Heating systems (cold-hot).
- Irrigation Systems.
- Drainage system.
- Rain Water System.
- Pump Room. (Submersible Pump, Water Pump).

Our Projects:



National Theatre - King Salman Park

Site: Riyadh, KSA.

Scope of work: Preparing Electromechanical Revit.

Model LOD 400

Client: King Salman Park Foundation

Consultant: Theatre Projects



El Alamein Towers

Site: El Alamein City, Egypt.

Scope of work: Preparing MEP& coordination
shop drawing

Main contractor: Hassan allam & CCC

MEP consultant: ECG



Villette Sodic New Cairo

Site: Cairo, Egypt.

Scope of work: Preparing complete
packageshop drawing for All systems

Client: Sodic

Main contractor: AL shams Company.

Consultant: Khatib & Alami.



The St. Regis Cairo

Site: Corniche El Nil, Cairo, Egypt
Scope of work: Preparing MEP Shop Drawing and As Built Drawing.
Main Contractor: CCC
MEP Contractor: Dark & Scull
MEP Consultant: Shaker



Dr Sulaiman Al Habib Hospital

Site: Riyadh, KSA.
Scope of work: Preparing Electromechanical Revit. Model LOD 400
Main contractor: Raka
MEP consultant: Shaker group



Kaust Secondary School

Site: Thuwal, KSA.
Scope of work: Preparing MEP& coordination shop drawing
MEP consultant: NV5

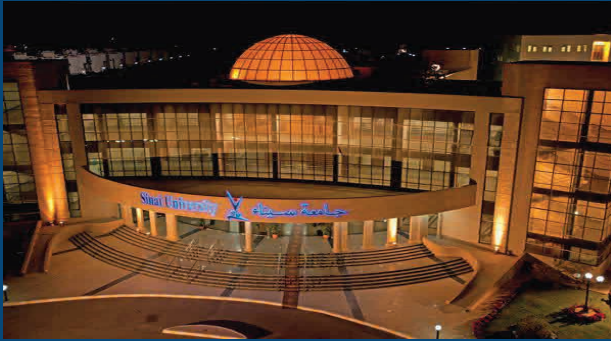

King Salman University

Site: South Of Sainai Egypt.
Scope of work: Preparing HVAC shop drawings.
MEP Consultant: Gaz



Oasis Residence

Site: Riyadh, KSA
Scope of work: Preparing complete package shop drawing for all systems.
Client: Oasis Residence for Real Estate Company
Consultant: RAKA



New Mansoura University

Site: New Mansoura, Egypt.
Scope of work: Preparing complete package shop drawing for site layout.
Client: Urban Communities Authority.
Main contractor: AL shams Company.



Qetaifan Island North (Beach Club)

Site: Qatar.
Scope of work: Preparing MEP & coordination shop drawing.
Main contractor: Qetaifan projects



Japanese Restaurant

Site: KSA.
Scope of work: Preparing MEP drawing & coordination shop drawing.
Main contractor: Raka
MEP consultant: Rma consultant



Presidential Palace - Mansoura 1

Site: New Administrative Capital, Egypt.
Scope of work: Preparing MEP, coordination shop drawing.
Main contractor: Hassan allam
Subcontractor: Roaya
MEP consultant: Shaken



Aljumum Mall Project

Site: Jeddah City (KSA).

Scope of work: Preparing complete package design and shop drawing for All systems.

Main contractor: Raka.

MEP consultant: RMA Consultant



Fayoum International Hospital

Site: Fayoum, Egypt.

Scope of work: preparing MEP shop drawing.

Main contractor: target Egypt

MEP Consultant: Creative

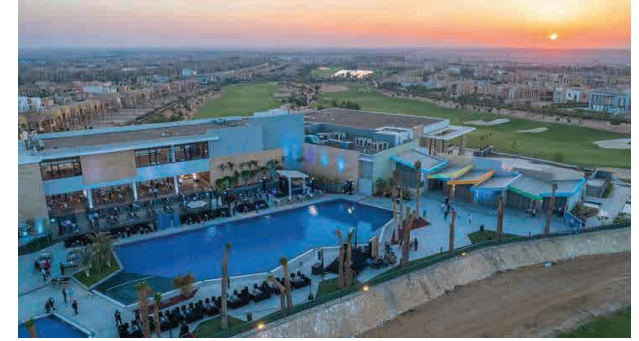

Vilette Club Sodic

Site: Cairo, Egypt.

Scope of work: Preparing complete package shop drawing for All systems

Client: Sodic

Main contractor: AL shams Company.

Consultant: RMC.



Amber Villa

Site: New Giza, Egypt.

Scope of work: Preparing MEP coordination shop drawing

Main contractor: Redcon

MEP consultant: Shaker



Alburouj Business Park

Site: Cairo - Ismailia Road, Egypt

Scope of work: Preparing Electromechanical drawing

Main contractor: Gama construction

MEP consultant: Raaft Miller (RMC)

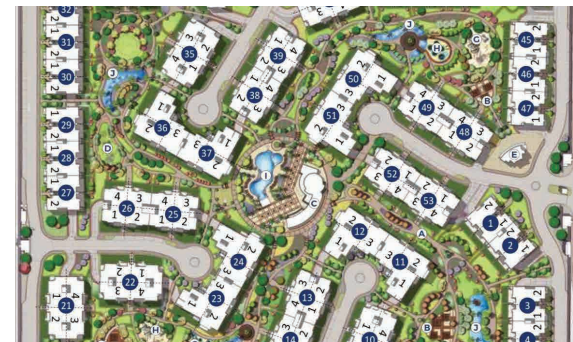

Compound Plaza Club

Site: Cairo. Egypt.

Scope of work: preparing infrastructure drawing.

Main contractor: Gek

MEP consultant: Shaker



Eastown Clubhouse

Site: New Cairo, Egypt.
Scope of work: Preparing MEP coordination shop drawing.
Sup contractor: JEC
MEP consultant: Shaker



Lycee Voltaire School

Site: New Giza.
Scope of work: Preparing MEP & Coordination shop drawing.
Main contractor: Civac



The Estates Sodic - Plot 03

Site: Cairo, Egypt
Scope of work: Preparing MEP shop drawings.
Client: Sodic
Consultant: New Vision – Design & PM



Cairo gate

Site: Sheikh Zayed, Egypt
Scope of work: Preparing MEP shop drawings.
Client: EMMAR
Consultant: ZFP

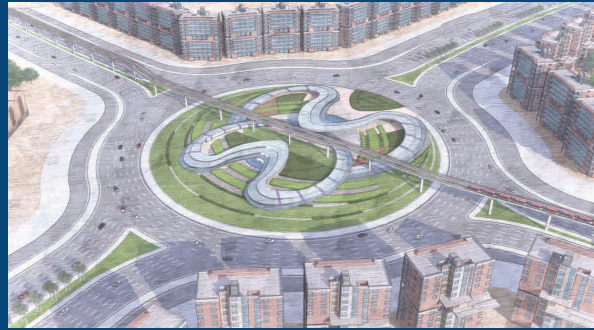

Cathedral Square

Site: New Administrative Capital, Egypt
Scope of work: Preparing Steel shop drawings.
Owner: New Urban Communities Authority
Consultant: ARCH. SPACE



JW Marriott Mena House Hotel

Site: Giza, Egypt.
Scope of work: Preparing fire, plumbing drawing
MEP contractor: LMS
MEP consultant: Sam & Line

Our Clients

ECG جماعة المهندسين للكشافة
ENGINEERING CONSULTANTS GROUP S.A.



HASSAN ALLAM
HOLDING



الشمس للمقاولات
ALSHAMS FOR CONTRACTING



TIBA CONTRACTING



SHAKER
CONSULTANCY GROUP



S.A.E.
Gec
شركة جيك للمقاولات العامة والكهربوميكانكية
General and Electromechanical
Company



شركة معمل البناء للمقاولات المحدودة

ATRIUM
Quality Contractors



مركز حضارية
هيئة المجتمعات العمرانية



مكتب هاني محمد عسيري
للاستشارات الهندسية



مركز للاستشارات الهندسية
MIDRAR A/E CONSULTANTS

HAEAHN
ARCHITECTURE

Contacts

Main Office:

36 Nadi Al Saeed, Dokki, Giza Governorate, Egypt.

Contact Info:

Tel: +20-233 360 459

Tel: +20-1150877754

Tel: +20-1152272722

Email: Info@sevenhandseg.com

Website: www.sevenhandseg.com

Business Development:

Email: bd@sevenhandseg.com

Mob: +20-11 03476764

Human Resources:

Email: hr@sevenhandseg.com

LinkedIn & Facebook:

SEVEN HANDS for Engineering Services and Construction

